

3 cabins - 2 head compartments

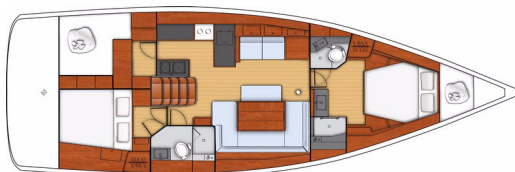

2 cabins - 2 head compartments

GENERAL SPECIFICATIONS

• Length overall	14,60 m	47'11"
• Hull length	14,27 m	46'10"
• L.W.L.	13,86 m	45'6"
• Hull Beam	4,74 m	15'7"
• Deep draft	2,17 m	7'1"
• Deep ballast weight	3 550 kg	7,826 lbs
• Shallow draft	1,83 m	6'
• Shallow ballast weight	4 060 kg	8,951 lbs
• Air draft	21,69 m	71'2"
• Light displacement	12 594 kg	27,765 lbs
• Fuel tank capacity (standard)	200 L	53 US Gal
• Fuel tank capacity (Optional equipment)	200 L	53 US Gal
• Freshwater capacity (standard)	370 L	98 US Gal
• Freshwater capacity (Optional equipment)	320 L	85 US Gal
• Engine power	75 HP	75 HP
	POD 120	POD 120

ARCHITECT / DESIGNERS

- Naval Architect: Berret Racoupeau Yacht Design
- Interior design: Nauta Design

CE CERTIFICATION

- Category A - 11 people
- Category B - 12 people
- Category C - 14 people

STANDARD SAIL LAYOUT AND AREA

• Mainsail (classic)	56,00 m ²	603 sq ft
• Genoa (105 %)	56,00 m ²	603 sq ft
• Asymmetrical spinnaker	130,00 m ²	1,400 sq ft
• I	18,75 m	61'6"
• J	6,06 m	19'11"
• P	17,09 m	56'1"
• E	5,55 m	18'3"



STANDARD EQUIPMENT

CONSTRUCTION

- Design made following European Directive requirements and according to EC certification
- Monolithic hull in polyester
- Monolithic structural hull liner bonded to the hull
- Injection molded deck in glass fiber/balsa sandwich, covered with «diamond-point» non-slip coating
- Deck hull joint screwed, bonded and banded with 1 solid wood bulwark
- Cast iron keel fixed with bolts and stainless steel backing plates
- Rudder hung with glass compound stock
- White colored hull - Grey metal hull decoration

DECK EQUIPMENT

RIGGING

- Standard mast 9/10 anodized aluminum installed on the deck, 2 sets of spreaders
- Anodized aluminum boom
- Discontinuous stainless steel standing rigging
- 2 Backstays with turnbuckles
- Rigid boom vang
- Genoa furling system with drum on the deck
- 2 Stand Up blocks on mainsheet arch
- 2 Genoa tracks with piston adjusted traveller cars
- 2 Genoa sheet return blocks
- Rigging run back to cockpit (except boom topping lift)
- Complete running rigging: Main halyard, Genoa halyard with clutch on mast and cleat, Boom topping lift with cleat on mast, Mainsheet, 2 Genoa sheets
- Reefing lines, 1 Manual reef
- 8 Line stoppers
- 2 Halyard bags

WINCHES

- 2 Self-tailing genoa sheet winches (H60.2 STC)
- 2 Self tailing coachroof winches (H46.2 STC)
- 2 Aluminum winch handles Speed Grip
- 2 Winch handle holders

SAILS

- Furling genoa with UV protective strip
- Semi full batten written sail with slider and roller slider
- System: Lazy Jack System and Lazy bag in Natural color

MOORING - ANCHORING GEAR

- Self-bailing chain locker - Clench bolt - Hatch cover
- Stainless steel bow fitting 2 rollers
- 12 V - 1500 W Vertical electric windlass - Remote control
- 6 Aluminum mooring cleats - Stainless steel deck line protection

SAIL LOCKER

- Access through deck hatch T60
- Stainless steel ladder
- Cubby hole lockers

SAFETY ON DECK

- 1 Open stainless steel forward pulpit
- 2 Stainless steel aft pushpits
- 1 Ring lifebuoy bracket
- 1 Outboard engine bracket
- Flag mounts welded on aft pushpit
- Double lifelines and stainless steel stanchions - Access to port and to starboard in lifelines

COCKPIT

- Self-bailing cockpit
- 2 Cockpit locker
- 2 Lockers in cockpit floor under helm's feet
- 1 Liferaft locker under helm seat (0,80 m x 0,40 m x 0,58 m / 2'7" x 1'4" x 1'4")
- 1 Gas locker for bottle(s) under the port helm seat
- Natural solid wood slatted cockpit benches
- 2 Steering wheel consoles: Stainless steel steering wheels - 900 mm diameter - Leather covered - Steering gear at the helm station - Metal cable transmission system - Stainless steel handrail - Navigation instrument pod (optional instruments) - Glass holder
- 1 Deck plate for access to tiller system + Power supply access hatch
- 1 Emergency tiller
- 2 Steering compass on consoles
- Portside engine control and control panel
- Polyester cockpit table - 2 Flaps - Glove boxes - 2 Large storage space - Stainless steel handrail - 12 V Power outlet - Lamp with shade
- Cold water cockpit shower
- 1 Fixed composite arch - Built-in lighting
- 1 Shore power socket to port
- 2 Hinged PMMA companionway doors - Sliding hatch made of PMMA

SWIM DECK / STERN DECK

- Fully opening transom, convertible into swim platform (2,85 m x 0,77 m / 9'4" x 2'6")
- Electrically controlled opening swim platform
- Natural solid wood decking on swim platform
- 1 Stainless steel swim/boarding ladder - Solid wood steps - Folding

INTERIOR

- Woodwork Alpi Mahogany
- Parquet type laminated floors
- Padding upholstery in salon and cabins
- Fabric upholstery
- Marine mattresses in the cabins

COMPANIONWAY

- Headroom: 1,98 m / 6'6"
- Wooden salon companionway with molded wood hanging steps with non-slip surface
- 2 Leather covered stainless steel handrails

SALON

- Headroom: 1,98 m / 6'6"
- U-shaped salon bench - Double density foam
- Seating on pantograph with backrest
- Salon table in 1 piece - Varnished wood top with inlay - Aluminum legs
- Mirror on bulkhead
- Cupboard units - Cubby hole lockers and storage along the hull - Storage under bench seats
- Cubbyholes with stainless steel beading
- 2 Panoramic deck house windows with concertina blinds
- 2 Hull portholes with curtain
- 2 Opening portholes on coaming in side windows
- 1 Opening deck hatch with shutter / Mosquito screen

CHART TABLE - PORTSIDE

- Sliding, can be configured with the armchairs - Placed against the forward bulkhead, against the galley or between the 2 mobile seats
- Table with flap - Molded wood beading
- Switch panel on bulkhead for access to electrical functions
- Navigation instrument panel (without instruments)
- 1 White reading light / Red

GALLEY - PORTSIDE

- Headroom: 1,90 m / 6'3"
- L-shaped galley with separate sink located below companionway
- Synthetic solid surface countertop in Jenna "Sand"
- 1 Stainless steel sink 2 rectangular basins - 1 Mixer tap cold water / hot water, under pressure
- 1 Gas stove 2 burners - Stainless steel oven on gimbal mountings - Stainless steel protection handrail
- 1 12 V 100 L ice box / 26 US Gal, top opening
- 1 12 V 130 L refrigerator / 34 US Gal, front opening
- Fitted cupboards and closed cubbyholes (Shelving, Garbage bin)
- 1 Lower cupboard: 1 Drawer - 2 Shelves
- Storage space along the hull
- 2 Opening ports on coaming with curtains on side windows

FORWARD CABIN

- Headroom: 1,92 m / 6'4"
- Central double bed (2,09 m x 1,55 m x 1,18 m / 6'10" x 5'1" x 3'10")
- Hanging lockers - Glove box - Cubby hole locker - Lower cupboard - Storage space under bed
- 2 Flush deck hatches with shutter / Mosquito screen
- 2 Hull portholes with curtain

FORE WASHROOM

Completely built in to the cabin with:

TO STARBOARD

- Moulded basin in grey work surface, Mixing tap hot water / Cold water
- 1 Washroom storage cabinet
- 1 Mirror
- 1 Glass shower cabin with flush access and storage on the bulkhead
- 1 Flush deck hatch with shutter / Mosquito screen

TO PORT

- Separate WC
- Hand basin
- Storage space along the hull
- 1 Flush deck hatch with shutter / Mosquito screen

STARBOARD AFT HEAD COMPARTMENT

- Headroom: 1,92 m / 6'4"
- Access through salon and the starboard aft cabin
- Separate shower - 1 Mixing tap hot water / Cold water - Storage on bulkhead
- 1 Manual marine toilet
- 1 Rigid holding tank 64L / 17 US Gal
- Sink - 1 Mixing tap hot water / Cold water
- 2 Mirrors
- Toilet accessories
- 1 Opening portlight with curtains in side windows in the coaming

STARBOARD AFT CABIN

- Headroom: 1,86 m / 6'1"
- 1 Double bed (2,09 m x 1,18 m x 1,55 m / 6'10" x 3'10" x 5'1")
- Access door to starboard aft washroom
- Cupboard units, Hanging locker, Closed cubbyholes, Storage each side of bed
- 1 Large size hull port with curtain
- 1 Opening deck hatch with shutter / Mosquito screen
- 1 Opening cockpit port with curtain
- 1 Glazing on companionway bulkhead

Version 2 cabins, 2 head compartments

AFT-GALLEY - PORTSIDE

- Headroom: 1,90 m / 6'3"
- Closed galley aft, accessible through galley
- Cupboard units, Shelves
- Dedicated position for a 5 kg washer drier (optional)
- 1 Opening deck hatch with shutter / Mosquito screen
- Direct access to cockpit locker (portside)

Version 3 cabins, 2 head compartments

PORT AFT CABIN

- Headroom: 1,86 m / 6'1"
- 1 Double bed (2,05 m x 1,35 m x 1,55 m / 6'9" x 4'5" x 5'1")
- Cupboard units, Hanging locker, Closed cubbyholes
- 1 Large size hull port with curtain
- 1 Opening deck hatch with shutter / Mosquito screen
- 1 Opening cockpit port with curtain
- 1 Glazing on companionway bulkhead

ENGINE

- Engine Yanmar Diesel 75 hp / 75 HP Sail Drive or POD 120 Dock & Go
- Engine control - Control panel in the port cockpit
- Engine compartment: Soundproofing foam - Ventilation: 1 air intake and 1 air outlet
- 1 Alternator 12 V / 125 Ah (Dock & Go: 1 Alternator 12 V / 120 Ah)
- 1 Rotomoulded diesel tank 200 L / 53 US Gal (under port aft berth) - Electronic gauge - Low level alarm - 1 Deck filler
- Filters: Sea water - Diesel - Decanter
- Fixed three blade propeller
- 1 Engine access through companionway (opening with 2 gas pistons) - 2 Engine access through aft cabins

ELECTRICITY

- 12 V Circuit
- 2 Service batteries (140 Ah) - 1 Engine battery (110 Ah)
- 1 Load balancer
- 12 V Electrical panel (Fuses - Voltmeter - Water gauge - Fuel gauge - Battery warning - Fuel warning - Water warning)
- 1 12 V Power outlets
- Lighting: Overhead lights - Reading lights - Reading light White/red - White striplighting
- Navigation lights: 1 Forward and aft navigation lights - 1 Engine navigation light / Deck light forward of mast - 1 Mooring light on masthead
- Wire runs for options cables
- Full 115 V system (Interior power outlet 115 V, 40 Amp battery charger, Shore power socket)

PLUMBING

- 1 Rotomolded freshwater tank (330 L / 87 US Gal Forward cabin) - 2 Deck fillers - Separate tank filling - Tank selection with ¼ by-pass valves
- Waterpressure system - Expansion tank - Inline filter
- 40 L Electric water heater / 11 US Gal (engine run)
- 1 Rigid holding tank 64L / 17 US Gal
- Delayed shower draining and electric shower drain pumps
- 1 Electric bilge pump - 1 Manual bilge pump
- 1 Electric ice box drain pump

GAS

- 1 Gas bottle box in the cockpit (diameter 0,34 m x 0,53 m / 1'1" x 1'9")
- Regulator and solenoid

TRIM LEVEL

	AVANTAGE	ELEGANCE
B&G Electronic - Helm consoles to port and starboard : 1 Multifunction Zeus 7" screen (GPS - Chart plotter - Chart reader - Cartography Navionics Silver included)	■	■
B&G Electronic : Wind Sensor (Windvane, Anemometer)	■	■
B&G Electronic : Sensor (Log - Speedometer - Temperature)	■	■
B&G Electronic : Wifi interface	■	■
Cockpit sole natural solid wood	■	■
Galley: Sea water foot pump + fresh water	■	■
LED: Navigation light - Interior lighting	■	■
Salon & Cabins: Indirect light LED	■	■
Hot water cockpit shower - Cold water	■	■
Additional diesel tank (200 L / 53 US Gal)	■	■
SonicHub - Interior speakers - Outside speakers	■	■
2 140 Amp additional service batteries + 1 40 Amp battery charger additional	■	■
Storage space(s) under the floor	■	■
Stainless steel beading for fenders in cockpit locker	■	■
Releasable fore-stay chain-plate		■
1 Port electric coachroof winch H46.2 STCEH		■
Polyester/wood cockpit table - White PVC protective cover		■
Galley: Top opening 12 V cool box in ice box - Freezer		■
Galley: Stainless steel 3 burner oven/grill cooker on deluxe mounting		■

PACKS

	DOCKING	EASY DOCKING	ELECTRONIC B&G
Windlass control in cockpit with chain counter	■	■	
White PVC steering wheel covers	■	■	
Moorings lines, Anchoring gear, fenders	■	■	
Bow thruster		■	
Swivel base on reverse side of cockpit table			■
Cockpit: Multifunction touchscreen B&G Zeus 12" wide (GPS, Chart plotter, Chart reader - Cartography Navionics Silver included)			■

VERSION

	DOCK & GO
Engine YANMAR Diesel Dock & Go POD 120	■
Swivel Sail Drive base	■
Joystick	■
Vessel Management Unit (VMU)	■
Bow thruster	■
Auto pilot	■

OPTIONS

Navigation electronics B&G

- 4G Radar
- AC 42 auto pilot + Control at steering station
- Chart table: Zeus 7" wide additional multifunction screen
- WR 20 Wireless autopilot remote control
- Chart table: Fixed B&G+V50 VHF, function AIS receiver + H50 cockpit handset
- AIS 400

Rigging - Sails

- 2 Flag halyards
- Releasable fore-stay chain-plate
- Asymmetrical spinnaker rigging + Code 0 Rigging
- Self-tacking jib hardware
- Code 0 on furler
- Self-tacking jib (replacing genoa)
- Self-tacking staysail with manual furling + Fixed forestay
- Anodized mast furling system with mainsail
- Genoa sheet track leads adjustable from the cockpit
- Backstays with turnbuckles (Adjustable)*

Winches

- 2 Electric genoa sheet winches H 60.2 STCEH

Hull - Deck

- Pearl Grey hull
- Blue-grey hull
- Solid wood slatted side decks
- Silver or Captain Blue Coachroof sprayhood
- Silver or Captain Blue Cockpit bimini
- Dark Naval, Silver or Captain Blue Cockpit cushions + Carbon Sky backrests
- 3 Blade folding propeller
- Refrigerated ice-box in cockpit table (30 L / 8 US Gal) - Positive cold
- Windex Windvane
- White composite steering wheels
- Stainless steel Arch with davits
- Mooring cleats - Stern deck
- Bow thruster

Interior equipment

- Water maker 60 L / 16 US Gal/h
- 7,5 KVA 115 V / 60 Hz Generator - with cocoon
- Dishwasher
- 115 V Air conditioning / 60 Hz
- Bose Acoustimass speakers
- Fuel forced-air heating system
- Microwave oven
- Double berth in salon
- Slat mattresses
- Additional holding tank
- Electric QUIET FLUSH head
- Extra water tank 2 x 160 L / 2 x 42 US Gal
- TV Combo DVD Prefit in Main Salon
- Mosquito screens
- 12 V / 115 V inverter 2000VA
- Grey upholstery padding in all cabins or Taupe
- Deluxe folding salon table (double berth compatible)
- White ceruse oak laminate flooring
- Interior upholstery: Fabric, Leather, Ultraleather

* Except on mast with in-mast furling

